

FOR LEASE

10604 KING GEORGE BOULEVARD, SURREY, BC

RETAIL OPPORTUNITY
AT NEWLY RENOVATED
DELL SHOPPING CENTRE



Gateway Station

SHOPPERS
DRUG MART

NESTERS MARKET

SUBWAY

Whalley Station Square
BC LIQUOR STORES

Subject Site

PHARMASAVE

Lucky Supermarket

DOLLARAMA

108TH AVENUE

EXPO LINE SKYTRAIN

WHALLEY AVENUE

138 STREET

105A AVENUE

UNIVERSITY DRIVE

CITY PARKWAY

KING GEORGE BOULEVARD



H&R BLOCK

Tim Hortons



104TH AVENUE

Surrey City Hall

HSBC

Layla Vera
Senior Associate
(604) 398 4352
Layla.Vera@MarcusMillichap.com

Jack Allpress
Senior Managing Director Investments
Personal Real Estate Corporation
(604) 638 1975
JAllpress@MarcusMillichap.com

Marcus & Millichap

FOR LEASE

10604 KING GOERGE BOULEVARD, SURREY, BC

DELL SHOPPING CENTRE



Major renovation has revitalized the appearance of the mall to that of a new shopping centre



Grocery anchor tenant opening in 2018



Improved access with the addition of a dedicated left-in turning lane off King George Blvd.

SALIENT DETAILS

Civic Address: 10650 King George Boulevard, Surrey, BC

Availability: Immediately

Zoning: C8 - Community Commercial Zone

Total Leasable Area: 121,287 SF

Additional Rent: \$13.66 (2021 est.)

Parking Stalls 337 stalls

Asking Rent: Please Contact Listing Agent



HIGHLIGHTS



Dell Shopping Centre is located on the northeast corner of King George Boulevard and 105A Avenue, just north of Surrey City Centre.



Significant public and private investment underway in the immediate area, rapidly evolving into one of Metro Vancouver's primary commercial districts.



Surrey is the fastest growing region in Metro Vancouver and as such the City Centre has become a desired location for high-density living within the city.

FOR LEASE

10604 KING GOERGE BOULEVARD, SURREY, BC

FUTURE SURREY CITY CENTRE

The adjacent map outlines the various development applications that are currently underway in the immediate area.

26	City Pointe	21 storey tower - 196 units 25 storey tower - 255 units
27	Proposed Residential	One 21 storey tower Two 18 storey tower
28	Proposed Residential	27 storey tower - 186 units
29	Proposed Residential	30 storey tower - 248 units 37 storey tower - 308 units 33 storey tower - 253 units
30	Gateway Business Park	2 office towers (1 built) - 500,000 SF Total 2 proposed residential towers - 450 units
31	Residential	4 storey - 91 units
32	Proposed Residential	4 storey - 69 units 6 storey - 82 units
33	Proposed Residential	5 storeys - 104 units
34	Quattro Development	374 units upon completion
35	Proposed Residential	4 storeys - 82 units
36	Proposed Residential	4 storeys - 71 units
37	Proposed Residential	6 storeys - 221 units



FOR LEASE

10604 KING GOERGE BOULEVARD, SURREY, BC

SITE PLAN

Unit	Size
27	Available - 4,331 SF

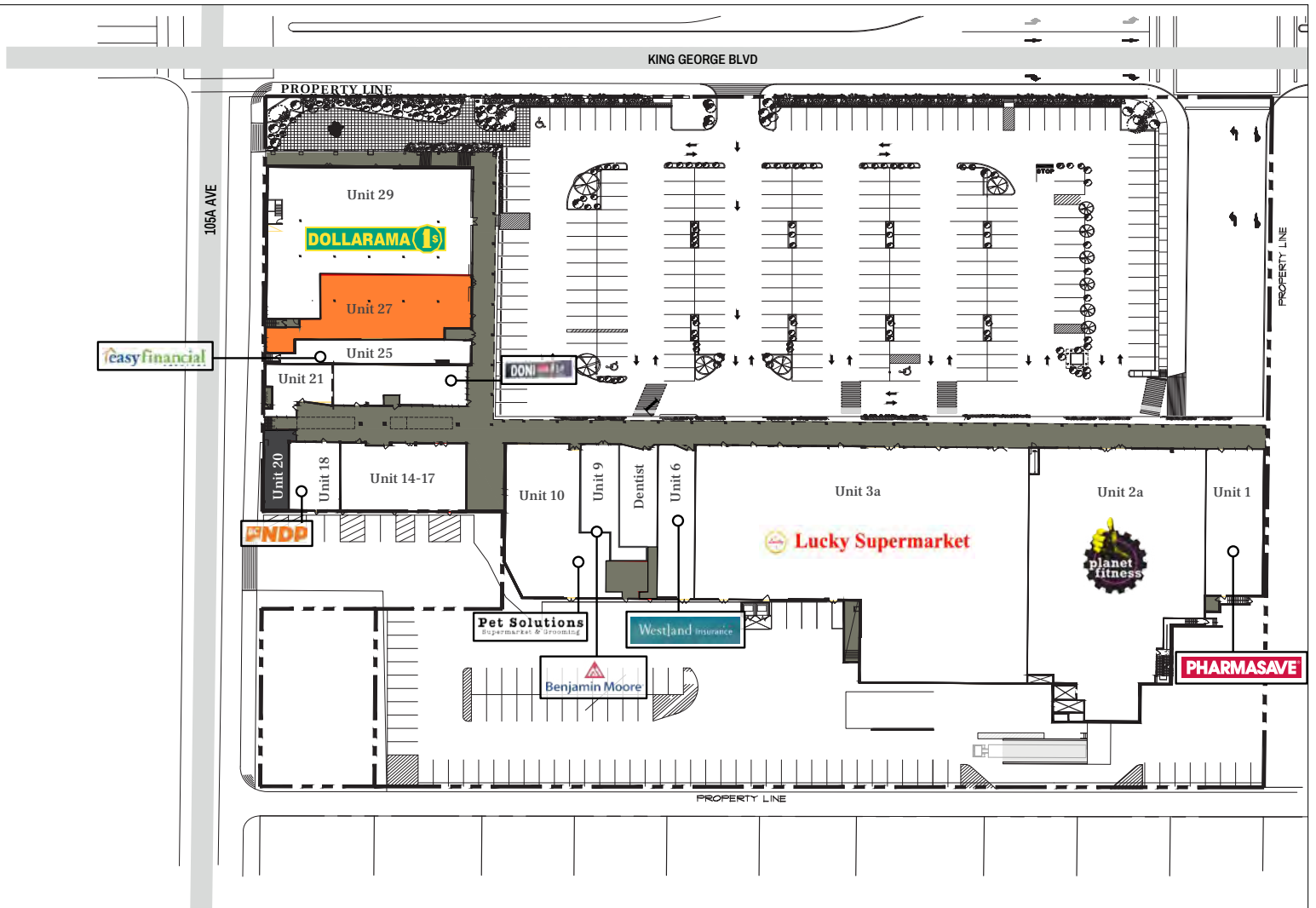

FOR LEASE

10604 KING GOERGE BOULEVARD, SURREY, BC

2020 Demographics	1 KM	3 KM	5 KM	Surrey
Population	15,404	91,058	214,531	574,657
Households	6,975	32,719	72,821	183,889
Average Household Income	\$68,934	\$80,738	\$91,819	\$110,097

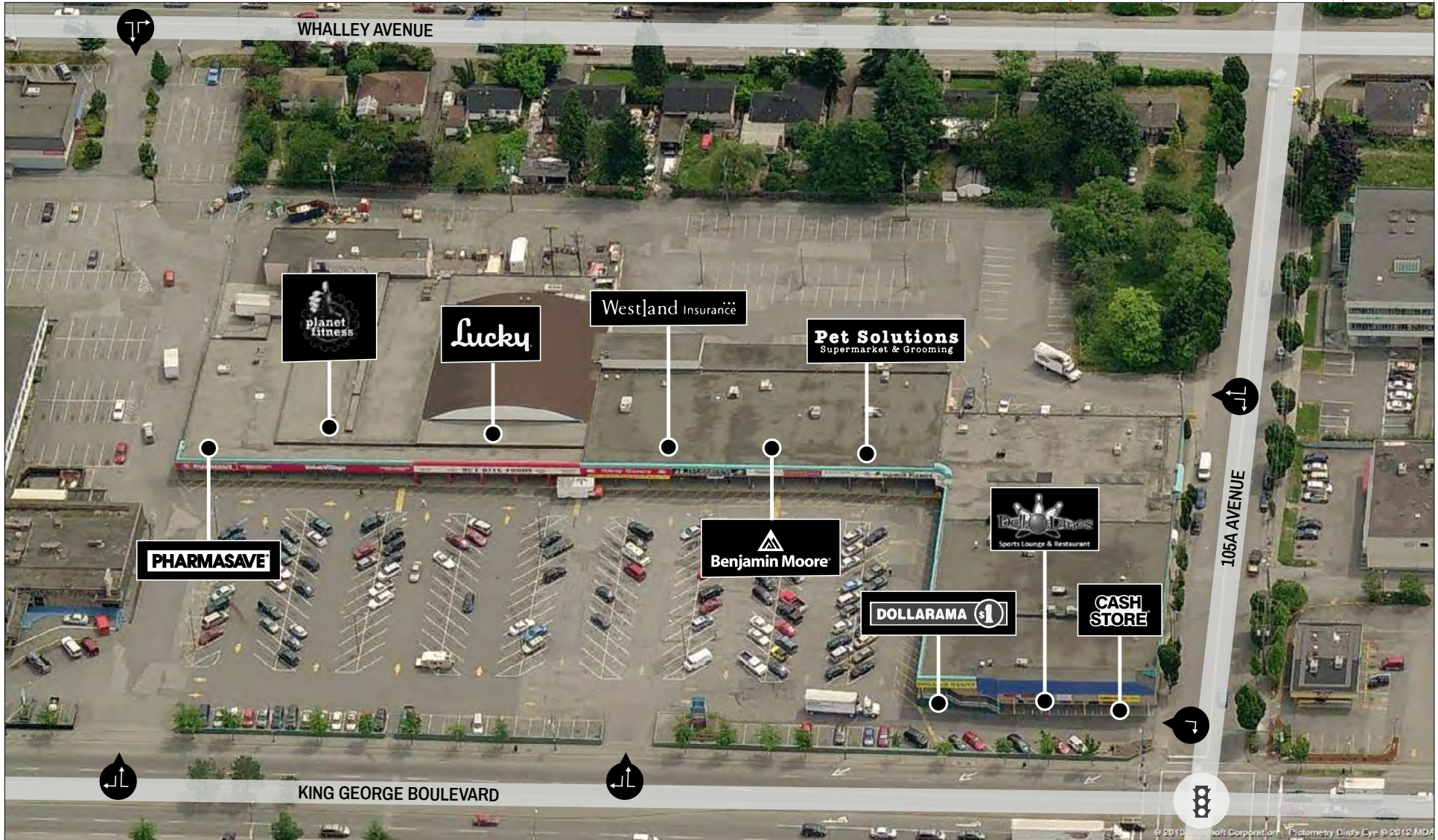

Marcus & Millichap

Marcus & Millichap
1280-333 Seymour Street
Vancouver, BC V6B 5A6

T (604) 638-2121
F (604) 638-2122

MarcusMillichap.ca

The information contained in the following Marketing Brochure is proprietary and strictly confidential. It is intended to be reviewed only by the party receiving it from Marcus & Millichap and should not be made available to any other person or entity without the written consent of Marcus & Millichap. This Marketing Brochure has been prepared to provide summary, unverified information to prospective purchasers, and to establish only a preliminary level of interest in the subject property. The information contained herein is not a substitute for a thorough due diligence investigation. Marcus & Millichap has not made any investigation, and makes no warranty or representation, with respect to the income or expenses for the subject property, the future projected financial performance of the property, the size and square footage of the property and improvements, the presence or absence of contaminating substances, PCB's or asbestos, the compliance with State and Federal regulations, the physical condition of the improvements thereon, or the financial condition or business prospects of any tenant, or any tenant's plans or intentions to continue its occupancy of the subject property. The information contained in this Marketing Brochure has been obtained from sources we believe to be reliable; however, Marcus & Millichap has not verified, and will not verify, any of the information contained herein, nor has Marcus & Millichap conducted any investigation regarding these matters and makes no warranty or representation whatsoever regarding the accuracy or completeness of the information provided. All potential buyers must take appropriate measures to verify all of the information set forth herein.

Marcus & Millichap is not affiliated with, sponsored by, or endorsed by any commercial tenant or lessee identified in this marketing package. The presence of any corporation's logo or name is not intended to indicate or imply affiliation with, or sponsorship or endorsement by, said corporation of Marcus & Millichap, its affiliates or subsidiaries, or any agent, product, service, or commercial listing of Marcus & Millichap, and is solely included for the purpose of providing tenant lessee information about this listing to prospective customers.

This information has been secured from sources we believe to be reliable, but we make no representations or warranties, express or implied, as to the accuracy of the information. References to square footage or age are approximate. Buyer must verify the information and bears all risk for any inaccuracies. Marcus & Millichap is a trademark of Marcus & Millichap Real Estate Investment Services, Inc. Used under license by Marcus & Millichap Real Estate Investment Services Canada Inc. © 2019 Marcus & Millichap. All rights reserved.